

General Description

Series GT valves isolate gauges from damage and inaccurate readings caused by line pressure surges and hydraulic hammer.

Operation

The GT has a push-to-read knob that delivers instant pressure to the gauge, yet isolates the gauge from the fluid line until the knob is pressed. When the knob is released, a spring-loaded spool closes instantly and drains all fluid from the gauge back into the reservoir.

Features

- Has a hardened steel spool.
- Partial snubbing action protects the gauge from surge damage.
- Optional panel mount.

Specifications

Maximum Operating Pressure	207 Bar (3000 PSI)
Mounting	In-line

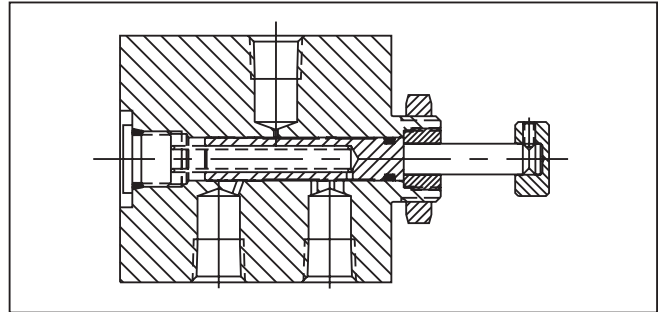
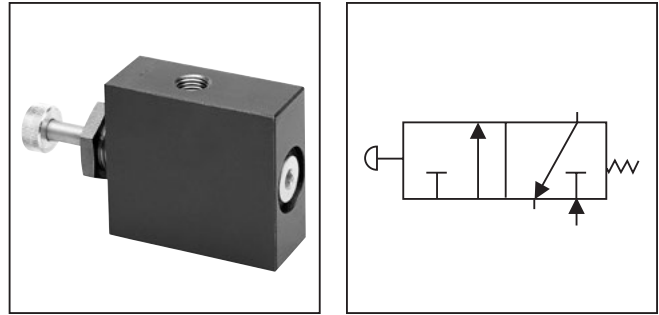

Ordering Information

Options		Series GT		Size	
Code	Description	Code	Description	Code	Description
Omit	NPTF/SAE	400	1/4"		
★9	BSP	420	7/16-20 UNF (SAE 4)		

★ Code 9 can be used with size 400

Material		Seal Compound		Design Series
Code	Description	Code	Description	NOTE:
S	Steel	Omit	Nitrile (Std.)	Not required when ordering.
		V	Fluorocarbon	

Weight: 1.0 kg (2.2 lbs.)

Dimensions

Inch equivalents for millimeter dimensions are shown in (**)

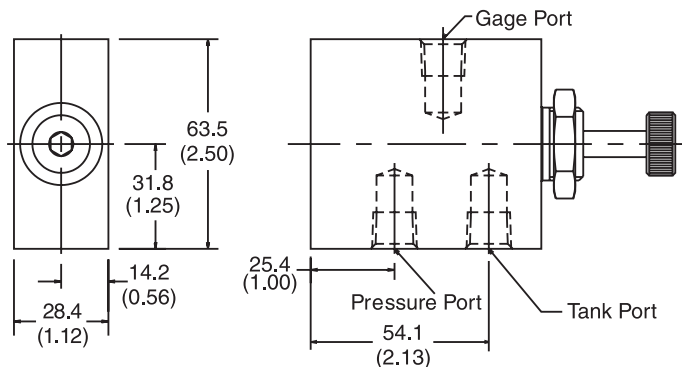
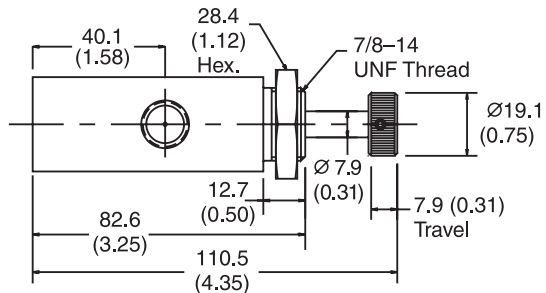

WARNING: This product can expose you to chemicals including Lead, Nickel (Metallic), or 1,3-Butadiene which are known to the State of California to cause cancer, and Lead or 1,3-Butadiene which is known to the State of California to cause birth defects and other reproductive harm. For more information go to www.P65Warnings.ca.gov.

Cat3300_02.indd, ddp, 04/19

